



Green Pin® Snatch Block

Snatch block type 601T

Highlights

- ✓ Smooth, uninterrupted pull due to conical roller bearings
- ✓ Coating assures long-term durability
- ✓ Lightweight
- ✓ Superior stock availability of 99%
- ✓ Reliable Green Pin® quality and support

Description

The Green Pin® Snatch Block is a light-weight snatch block type 601T. The snatch block has a smooth, uninterrupted pull due to its conical roller bearings. The coating of the Green Pin® Snatch Block ensures long-term durability, even under harsh conditions. The product is available in a range with a working load limit from 4 up to 8 ton.

Product details

Productcode	P-6953
Material	carbon steel, fitted with conical roller bearings
Safety factor	MBL equals 4 x WLL
Finish	painted
Certification	2.1 2.2 MTCb CE
Note	Working Load Limit is on the headfitting



Green Pin® Snatch Block

Technical specifications in millimeters

Article code	working load limit	diameter wire rope	A diameter outside sheave	B length	C thickness	D width outside	Net weight (kg)
BKOFFST0404	4	10 - 12	115	213	83	120	4
BKOFFST0608	8	20 - 22	152	305	108	160	9
BKOFFST0808	8	20 - 22	203	357	108	210	12
BKOFFST1008	8	20 - 22	254	406	108	260	18

www.greenpin.com



Green Pin® Snatch Block

Technical specifications in inches

Article code	Working load limit	diameter wire rope (inch)	A diameter Outside sheave (inch)	B length (inch)	C thickness (inch)	D width outside (inch)	Net weight (LBS)
BKOFFST0404	4	3/8 - 1/2	4 1/2	8 3/8	3 9/32	4 23/32	8.82
BKOFFST0608	8	3/4 - 7/8	6	12	4 1/4	6 5/16	19.9
BKOFFST0808	8	3/4 - 7/8	8	14 1/16	4 1/4	8 9/32	26.5
BKOFFST1008	8	3/4 - 7/8	10	15 31/32	4 1/4	10 1/4	39.7

www.greenpin.com



Green Pin® Snatch Block

Technical drawing

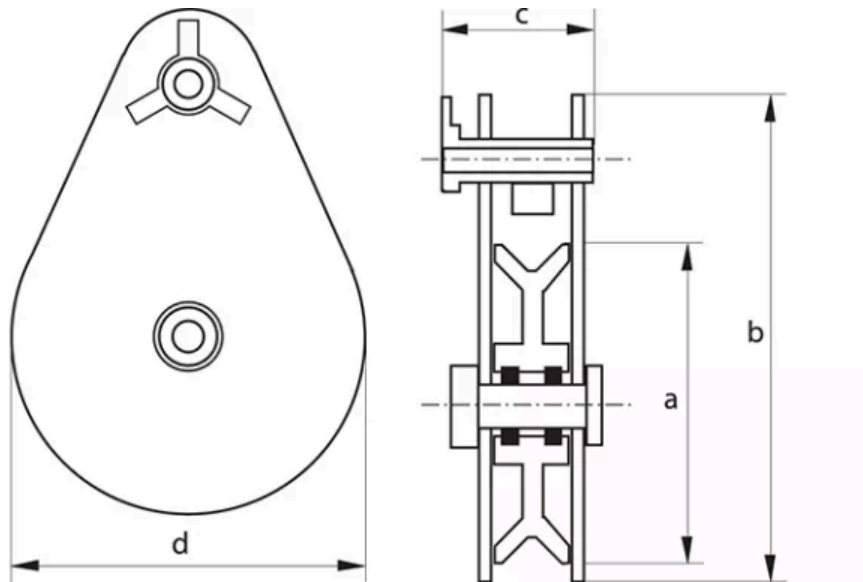

www.greenpin.com